

Swivel castor with wheel brake 531 M10 75 P

Furniture Castors Series 530 GW - Wheel P

 -20 °C - +60 °C

- swivels easily
- wear resistant
- shock proof
- floor protective
- weather proof

Wheel

Casted high quality nylon wheel black

High quality nylon housing - black

Swivel bearing with combined
plain-ball bearing

Wheel brake - glass fibre reinforced

Wheel axle revited

Swivel castor with wheel brake	Wheel-Ø A x width B mm: 75x13+13
-----------------------------------	----------------------------------

Load Capacity kg:	60
-------------------	----

Load capacity tested according to EN 12530 and EN 12527

Overall height H mm:	93
----------------------	----

Threat mm:	M10x15
------------	--------

Swivel radius SR mm:	88
----------------------	----

Wheel bearing:	Nylon plain bearing
----------------	---------------------

Advantages

- ✓ easy running on smooth floors
- ✓ impact proof
- ✓ high abrasion resistance
- ✓ easy to clean
- ✓ high chemical resistance

©Copyright 2024 Rollenbau GmbH, www.rollenbau.at 20.05.2024

 ROLLENBAU

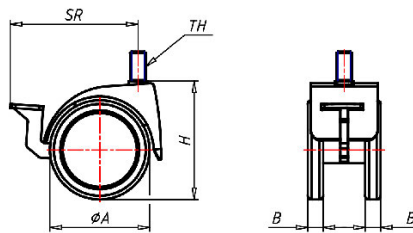

Applications

- Health-Professionals